



PRIVATE EVENTS



MANDARIN ORIENTAL
MAYFAIR LONDON



HOST YOUR SPECIAL EVENT WITH US

AT MANDARIN ORIENTAL MAYFAIR, LONDON

Host an unforgettable celebration in one of London's most exclusive neighbourhoods with the exceptional dining experience at Mandarin Oriental Mayfair, London.

Discover a refined yet relaxed dining concept presenting a contemporary European cuisine.

Begin your evening with a champagne reception before savouring an exquisite selection of dishes, crafted with innovation and precision.

As the night unfolds, elevate the experience at Hanover Bar, where expertly crafted cocktails and breathtaking views set the scene for a truly memorable occasion.

From intimate gatherings to grand celebrations, our dedicated team ensures a seamless experience, tailored to your vision.



SPECIAL EVENTS

TRADITIONAL INFLUENCES, MODERN INTERPRETATION



Designed for exclusivity, Atrium Restaurant offers three private dining rooms.

Our menus celebrate the vibrant simplicity of modern European cuisine, created with locally sourced, organic, and sustainable ingredients.

Each dish is expertly paired with hand-selected wines, ensuring an elevated dining experience.

Whether planning an elegant sit-down dinner, a business breakfast, or a champagne-fuelled celebration, our versatile spaces cater to every need.



SPECIAL EVENTS

WATER

SUI



The most distinguished of the meeting rooms, Sui, meaning 'water' in Japanese, boasts a remarkable early example of an art deco interior.

With its striking installations and unique design, Sui offers a memorable setting for any event, whether business or pleasure.

For larger events Sui is connected to Kai for up to 34 guests for dinner or 50 for a reception.

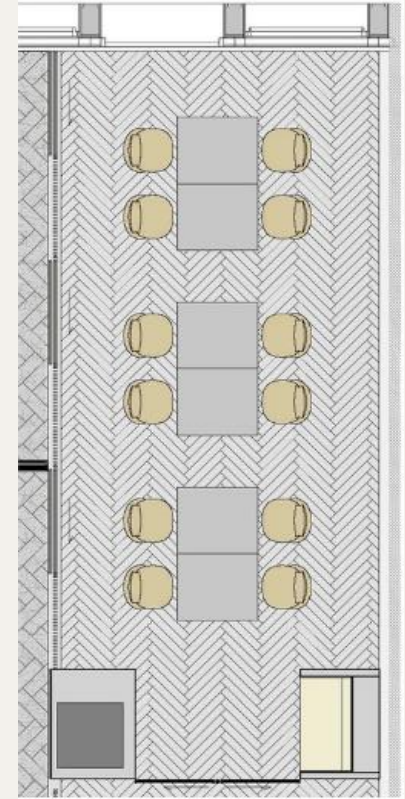

SIZE

24.9SQM/ 267.5SQF

DIMENSIONS (L x W)

3.5M x 7M

CAPACITY

DINNER

20

RECEPTION

20

THEATRE

12

BOARDROOM

16

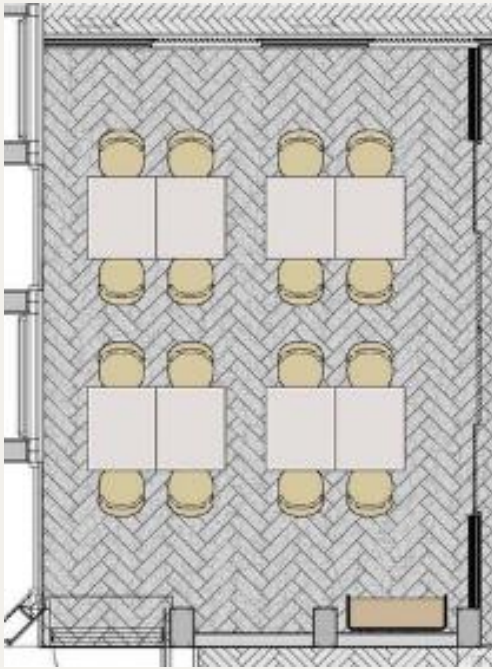

SIZE

27.6SQM / 297SQF

DIMENSIONS (L x W)

6M x 4.6M

CAPACITY

DINNER

16

RECEPTION

25

THEATRE

20

BOARDROOM

14

Perfect for all occasions, gather your loved ones for a celebration like no other or unite your peers for business in Ka, meaning 'Fire' in Japanese.

Ka welcomes 16 guests for a dining experience or up to 25 for a canapé reception. Seating arrangements are adjustable for theatre and boardroom styles. Enquire with our team to create a tailored package that meets your needs.

FIRE

KA



SUI + KA

For larger gatherings, this elegant L-shaped space is ideal for hosting cocktail parties or celebratory dinners.

Whether you're dining, networking, or conducting meetings, the impeccable flow between rooms ensures guests enjoy a seamless and spacious experience while preserving the intimacy and exclusivity of a private setting.

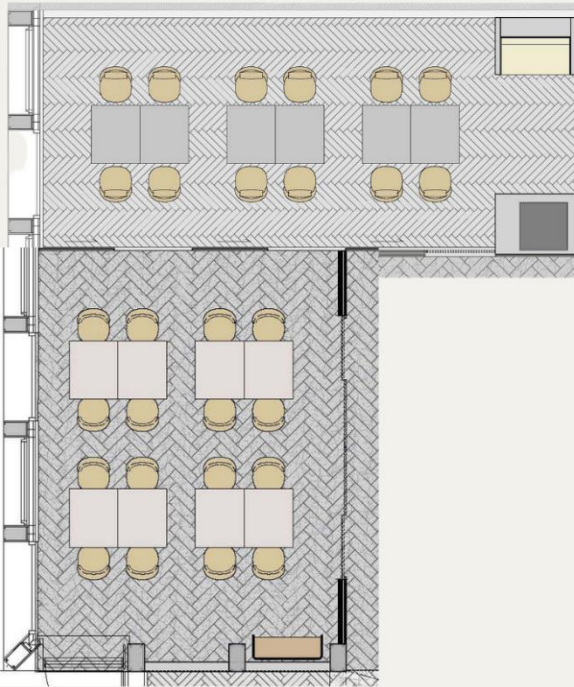

SIZE

52.5SQM / 564.6SQF

DIMENSIONS (L x W)

9.6M x 7M

CAPACITY

DINNER

34

RECEPTION

50

THEATRE

20

BOARDROOM

16

EARTH

CHI

地

Our most intimate meeting room, Chi, meaning 'earth' in Japanese, offers a unique experience for up to 7 diners.

With its natural interior and a pop of character, Chi is the ideal location for a cosy celebration or morning meeting.

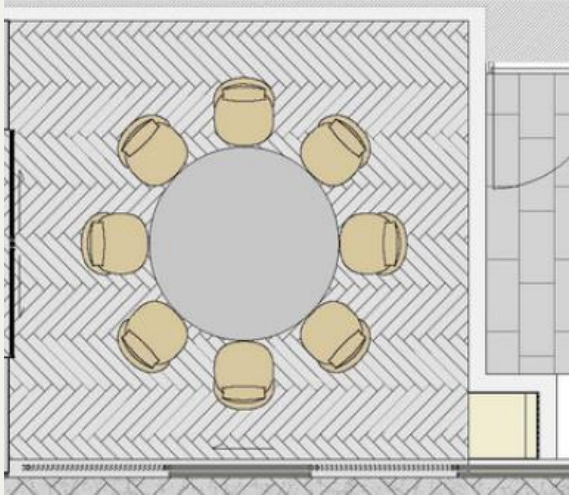

SIZE

13 SQM / 140 SQF

DIMENSIONS (L x W)

3.65M x 5.56M

CAPACITY

DINNER

7

RECEPTION

-

THEATRE

-

BOARDROOM

4



ATRIUM RESTAURANT

Step into a warm and inviting atmosphere of the Atrium Restaurant, where the dramatic design elements of earth, wind and water are seamlessly integrated. The breathtaking triple height sky roof and the elegant marble circular staircase create a stunning entrance that complements the exquisite décor, designed to stimulate the senses. This dramatic setting is perfect for enjoying a refined yet relaxed dining concept, complemented by our extensive wine list and the intuitive, expert service for which Mandarin Oriental is renowned.

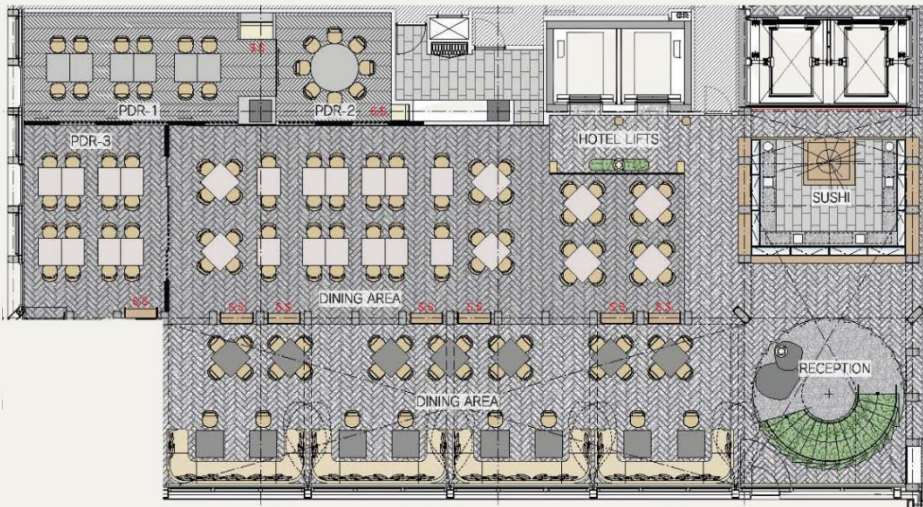

SIZE

27.6SQM / 297SQF

DIMENSIONS (L x W)

6M x 4.6M

CAPACITY

DINNER
80
RECEPTION
150
THEATRE
-
BOARDROOM
-

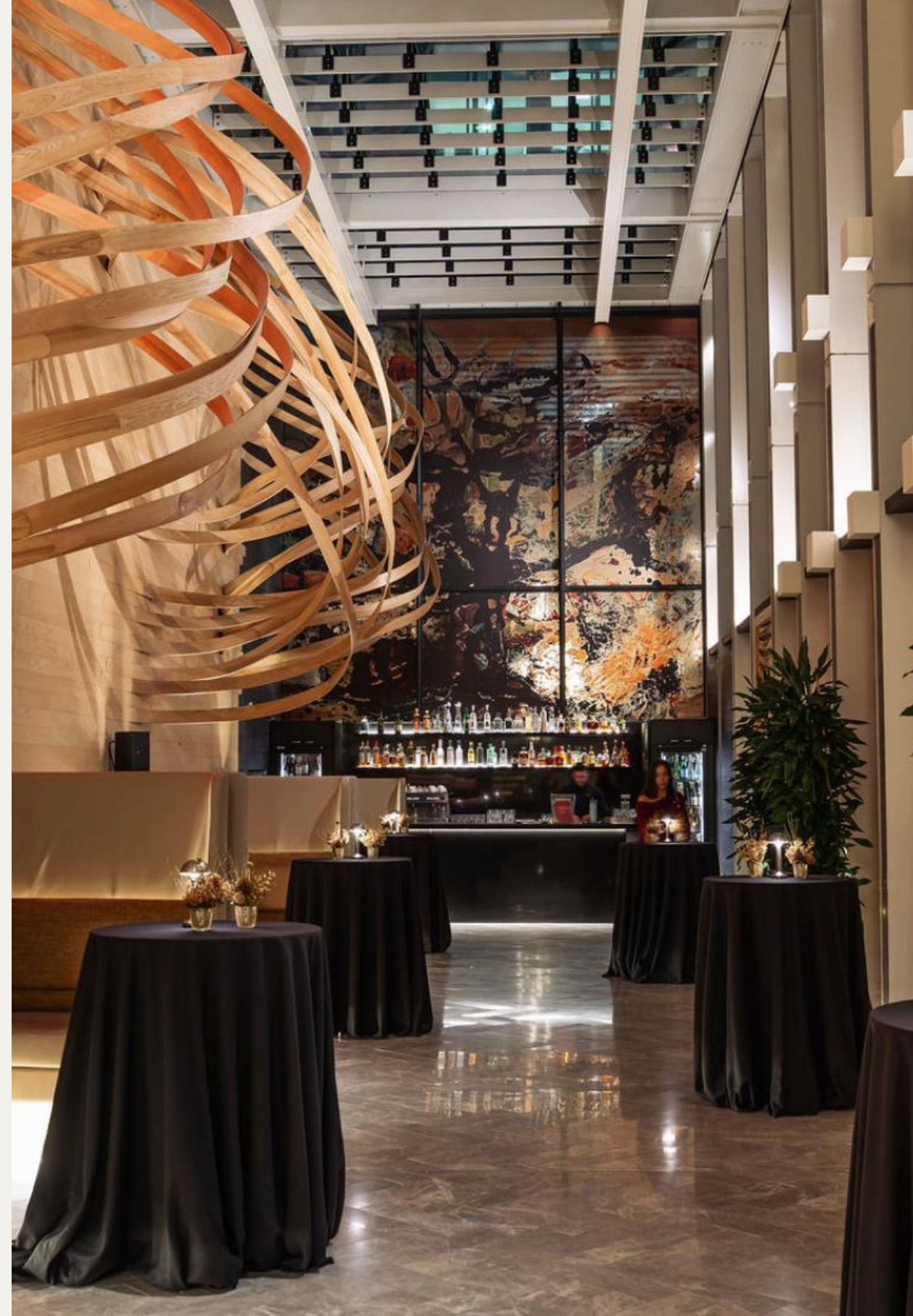

PRIVATE CHEFS TABLE

Formerly Somssi by Jihun Kim, our private Chef's Table offers an exclusive and intimate dining experience, featuring a bespoke tasting menu created for a select number of guests.

Set within a refined and elegant space, guests are invited to witness the artistry behind each dish as our talented chefs prepare and present the menu live, creating a truly immersive and memorable occasion.

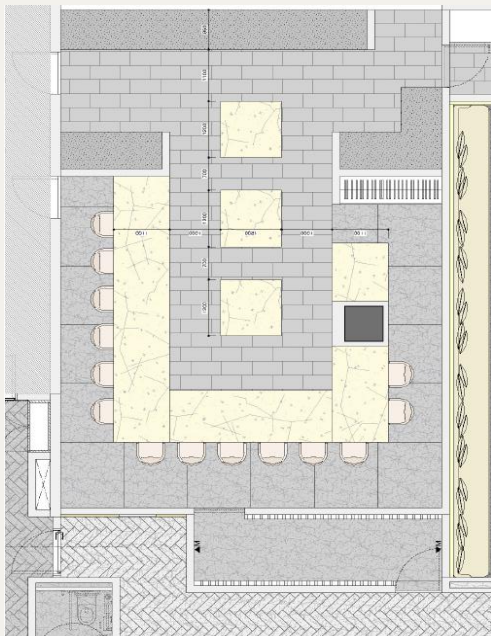

SIZE

53SQM / 570.5SQF

DIMENSIONS (L x W)

6M x 4.6M

CAPACITY

DINNER
14

RECEPTION

-

THEATRE

-

BOARDROOM

-



HANOVER BAR

Hanover Bar at Mandarin Oriental Mayfair introduces a fresh perspective to London's bar scene. This 50-seat rooftop bar with an outdoor terrace offers sweeping views over Mayfair to landmarks like Hampstead Heath and the London Eye. Its cocktail menu takes inspiration from the neighbourhood's most iconic spots, blending elegance, heritage and flavour in every sip.

Available for semi-private hire, Hanover Bar pairs expertly crafted cocktails with light daytime dishes and savoury evening options. The elegant interior, with sky-inspired hues and a cloud-like chandelier, enhances the experience, while floor-to-ceiling windows frame iconic views of the city. Open daily, with visiting DJs, Hanover Bar is a destination for an exclusive, elevated experience.

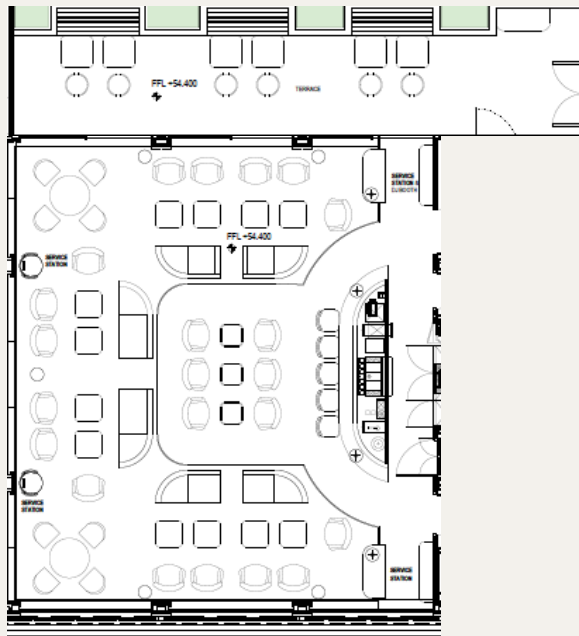
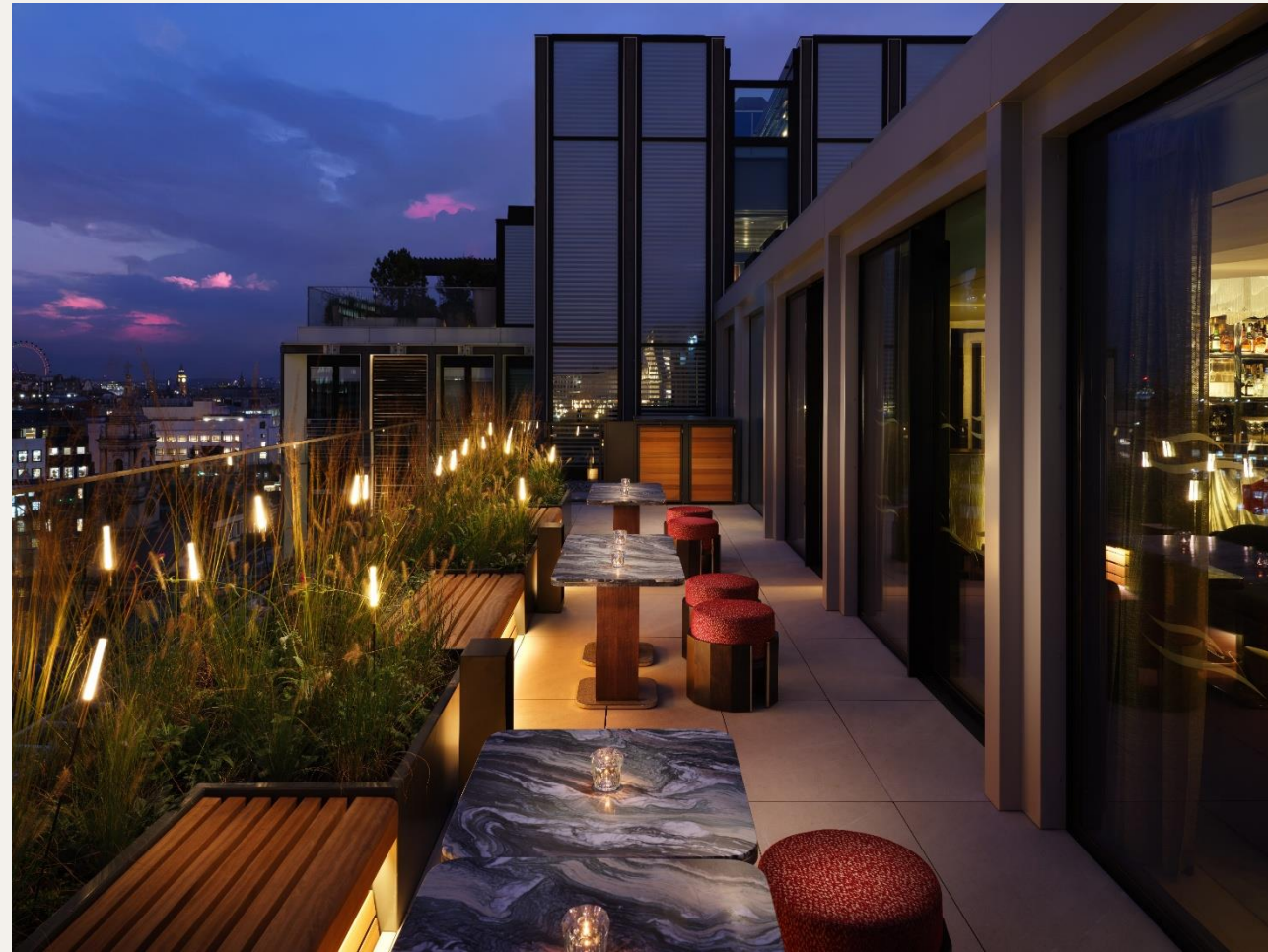

SIZE

Indoor: 97SQM / 1044SQF
Outdoor: 37SQM/398.2SQF

DIMENSIONS (L x W)

9.3M x 10.5M

CAPACITY

DINNER

-

RECEPTION

25 (Semi-Privatisation)

THEATRE

-

BOARDROOM

-

ESMERALDA'S

Esmeralda's is a hidden late-night lounge within Mandarin Oriental Mayfair, where live music and indulgence set the tone. Inspired by the golden age of New York's live lounge. The resident band is the defining soul of Esmeralda's. A curated experience that sets the room aglow with an elegant and modern energy. Our signature band blends soul, funk and disco into a contemporary performance that re-imagines the classic live music lounge. Each set feels intimate yet electric, a feeling which defines the bar itself.

Nestled on the lower ground floor of the Mandarin Oriental Mayfair. Esmeralda's is a single, self-contained bar room designed as an intimate world of its own. The space offers a deeply atmospheric setting, crafted for both seated gatherings and late-night energy. Wrapped in velvet drapery, illuminated by golden, low-lit ambience, and framed by Esmeralda's iconic sculptural ringed walls, the room exudes a plush, seductive sophistication. Rich textures, curved seating, and intimate table arrangements create a space that feels both luxurious and inviting, tailored for live music, conversation, and the unexpected.

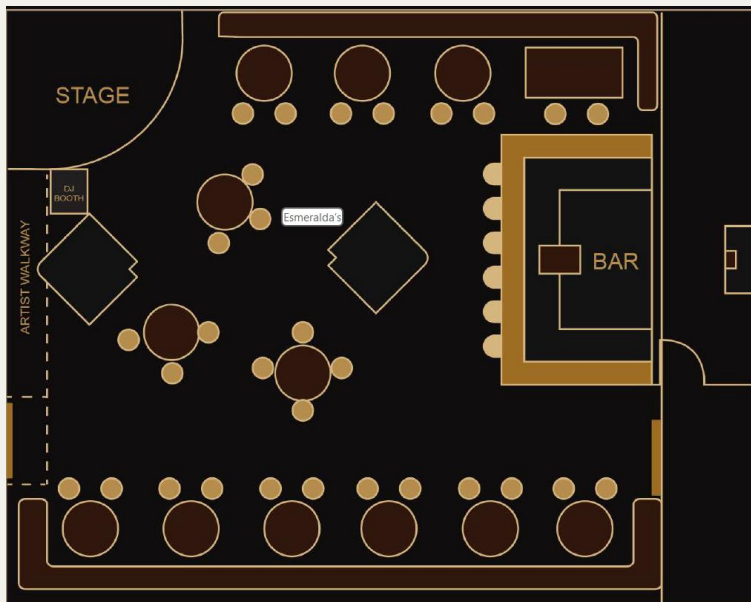

CAPACITY

DINNER
40

RECEPTION
80

-



EVENT ROOM CAPACITIES

Allow us to host your party from start to finish and immerse yourself within the vibrant atmosphere of Mandarin Oriental Mayfair with our tailored packages.

SUI	KA	SUI+KA	CHI	ATRIUM	PRIVATE CHEFS TABLE	HANOVER BAR
DINNER	DINNER	DINNER	DINNER	DINNER	DINNER	DINNER
20	16	34	7	80	14	-
RECEPTION	RECEPTION	RECEPTION	RECEPTION	RECEPTION	RECEPTION	RECEPTION
20	25	50	-	150	-	25 (semi-private)
THEATRE	THEATRE	THEATRE	THEATRE	THEATRE	THEATRE	THEATRE
12	20	20	-	-	-	-
BOARDROOM	BOARDROOM	BOARDROOM	BOARDROOM	BOARDROOM	BOARDROOM	BOARDROOM
16	14	16	4	-	-	-



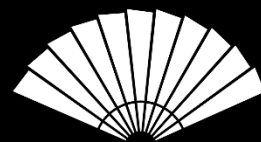

MANDARIN ORIENTAL

MAYFAIR LONDON

22 Hanover Square
Mayfair, London, W1S 1JP, United Kingdom
Telephone + 44 (0)20 7889 8888
mandarinoriental.com/mayfair